

LARGEST MINI BUCKET MANUFACTURE IN CHINA

MINI EXCAVATOR BUCKET

UP TO 8T/18000lbs

GENERAL PURPOSE

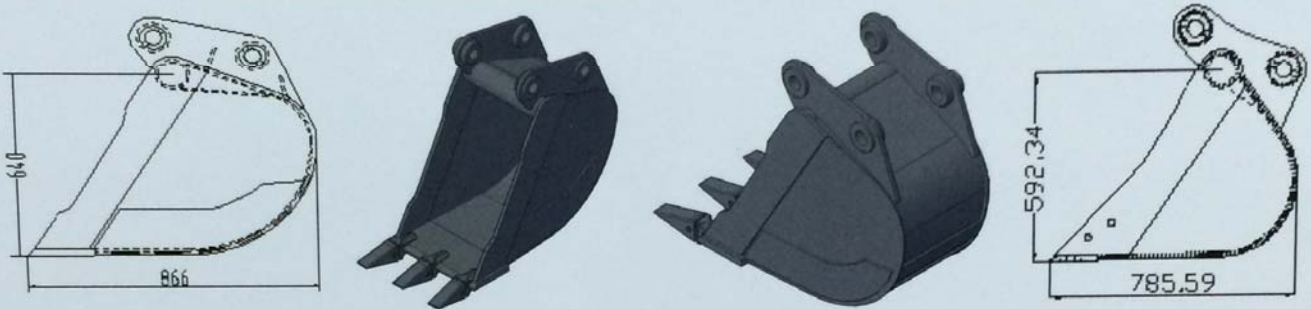

High Capacity Heavy Duty

Standard Capacity Heavy Duty

Machine Weight	Width (mm)	Width (inch)	Volume (VRm3)	Teeth	Mass(kg)	Mass(lbs)
0.75t	200	9		3	26.50	58
0.75t	300	12		3	36.00	79
0.75t	450	18		4	46.00	101
1t-2t						
1t-2t	230	9	0.01	3	38.00	84
1t-2t	300	12	0.1	3	47.30	104
1t-2t	450	18	0.03	4	59.80	132
1t-2t	600	24	0.04	5	68.00	150
2t-3t	230	9	0.02	3	52.00	114
2t-3t	300	12	0.03	3	59.00	130
2t-3t	450	18	0.05	4	73.00	161
2t-3t	600	24	0.08	5	86.00	189
3t-4t	300	12	0.06	3	80.50	177
3t-4t	450	18	0.1	4	104.72	230
3t-4t	600	24	0.14	5	125.50	276
5t-6t	300	12	0.08	3	97.50	215
5t-6t	450	18	0.13	4	115.50	254
5t-6t	600	24	0.18	5	132.50	292
6t-8t	300	12	0.09	3	158.00	348
6t-8t	450	18	0.16	4	184.00	405
6t-8t	600	24	0.23	5	214.00	471
6t-8t	900	36	0.38	5	263.00	579

GENERAL PURPOSE BUCKET

FROM 12t/27000lbs UP TO 1250T /280000lbs

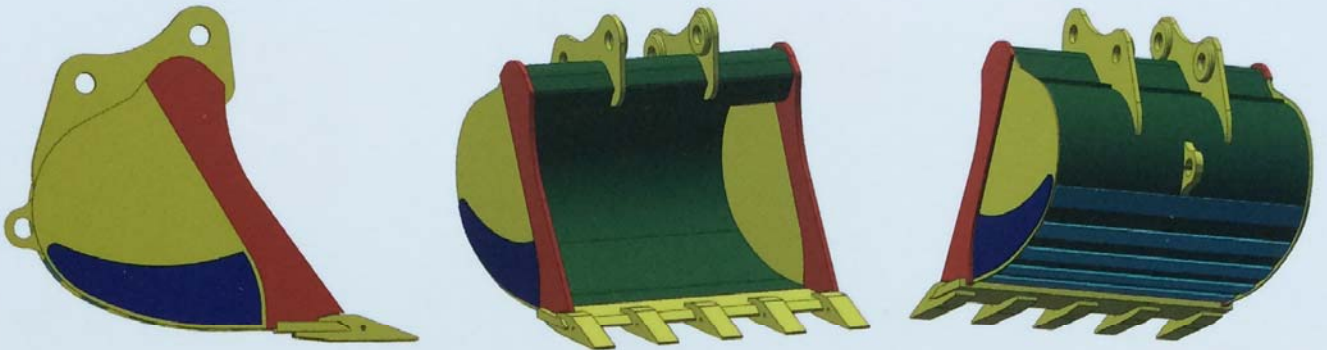

Machine Weight	Width(mm)	Width (inch)	Volume (VRm3)	Teeth	Mass(kg)	Mass(lbs)
10T-13T	450	18	0.24	3	315.7	695
10T-13T	600	24	0.32	3	357.3	786
10T-13T	750	30	0.43	3	399.1	878
10T-13T	900	36	0.54	4	440.7	970
10T-13T	1000	39	0.58	4	461.7	1016
10T-13T	1050	42	0.65	5	482.5	1062
10T-13T	1200	48	0.76	5	524.2	1153
13T-17T	450	18	0.25	3	407.6	897
13T-17T	600	24	0.344	3	463.9	1021
13T-17T	750	30	0.462	3	520.6	1145
13T-17T	900	36	0.51	4	576.9	1269
13T-17T	1000	39	0.584	4	605.3	1332
13T-17T	1050	42	0.704	5	633.3	1393
13T-17T	1200	48	0.826	5	690.2	1518
13T-17T	1380	54	0.947	6	746.8	1643
18T-22T	600	24	0.39	3	515.5	1134
18T-22T	750	30	0.52	3	580.5	1277
18T-22T	900	36	0.654	4	645.5	1420
18T-22T	1000	39	0.722	4	678.2	1492
18T-22T	1050	42	0.79	5	710.6	1563
18T-22T	1200	48	0.927	5	775.8	1707
18T-22T	1380	54	1.063	6	840.7	1850
18T-22T	1500	60	1.2	6	905.7	1993
23T-27T	600	24	0.385	3	645.6	1420
23T-27T	750	30	0.535	3	712.8	1568
23T-27T	900	36	0.69	3	780	1716
23T-27T	1000	39	0.769	3	813.8	1790
23T-27T	1050	42	0.849	4	847.4	1864
23T-27T	1200	48	1.011	4	914.6	2012
23T-27T	1380	54	1.173	5	982.1	2161
23T-27T	1500	60	1.335	5	1049.2	2308
23T-27T	1600	63	1.416	5	1082.9	2382
23T-27T	1680	66	1.497	5	1116.4	2456

ROCK STYLE BUCKET

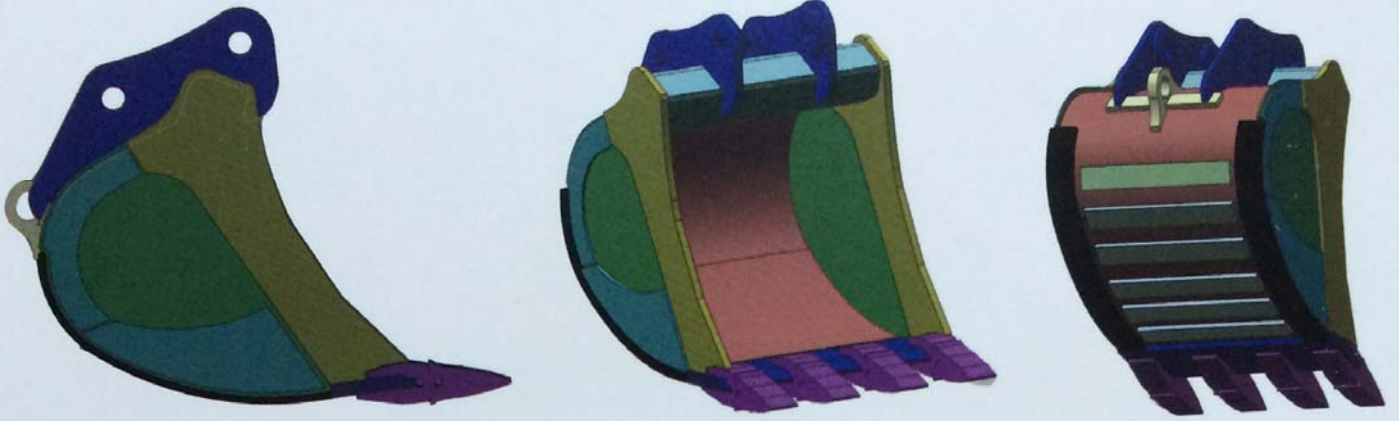

Machine Weight	Width (mm)	Width (inch)	Volume (VRm3)	Teeth	Mass(kg)	Mass(lbs)
18T-22T	600	24	0.39	3	571.4	1257
18T-22T	750	30	0.52	3	639.3	1406
18T-22T	900	36	0.654	4	707.2	1556
18T-22T	1000	39	0.722	4	741.2	1631
18T-22T	1050	42	0.79	5	775.3	1706
18T-22T	1200	48	0.927	5	843.4	1855
18T-22T	1380	54	1.063	6	903.8	1988
18T-22T	1500	60	1.2	6	971.7	2138
23T-27T	600	24	0.385	3	713.2	1569
23T-27T	750	30	0.535	3	784.6	1726
23T-27T	900	36	0.69	3	856.1	1883
23T-27T	1000	39	0.769	3	892.1	1963
23T-27T	1050	42	0.849	4	927.8	2041
23T-27T	1200	48	1.011	4	999.3	2198
23T-27T	1380	54	1.173	5	1071.1	2356
23T-27T	1500	60	1.335	5	1142.5	2514
23T-27T	1600	63	1.416	5	1178.4	2592
23T-27T	1680	66	1.497	5	1214	2671
27T-30T	600	24	0.469	3	821.3	1807
27T-30T	750	30	0.651	3	895.8	1971
27T-30T	900	36	0.841	3	971.3	2137
27T-30T	1000	39	0.938	3	1009.4	2221
27T-30T	1050	42	1.038	4	1047.6	2305
27T-30T	1200	48	1.237	4	1124.2	2473
27T-30T	1380	54	1.439	5	1201	2642
27T-30T	1500	60	1.641	5	1277.6	2811

ROCK STYLE BUCKET

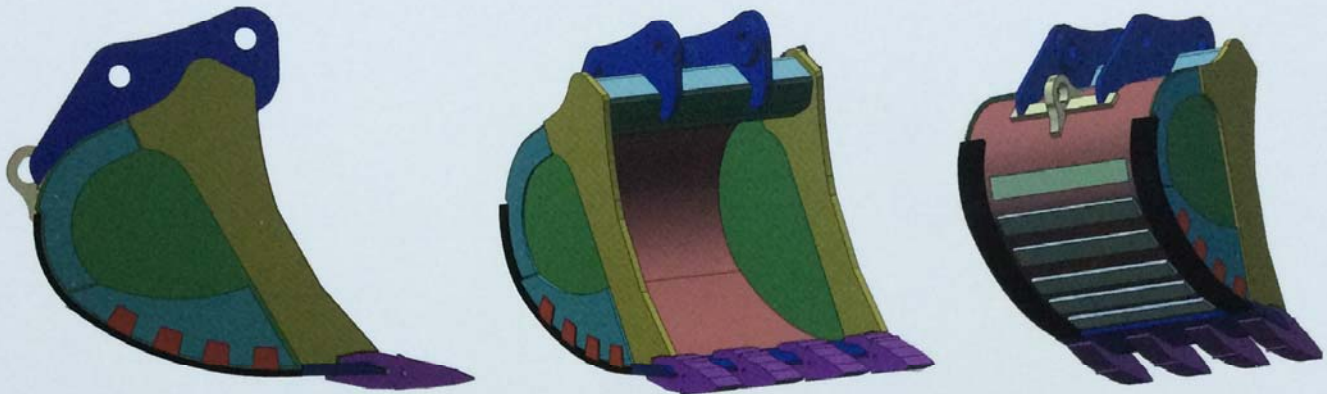

Machine Weight	Width (mm)	Width (inch)	Volume (VRm ³)	Teeth	Mass(kg)	Mass(lbs)
27T-30T	1600	63	1.742	5	1315.9	2895
27T-30T	1680	66	1.842	5	1354	2979
30T-36T	750	30	0.663	3	1146	2521
30T-36T	900	36	0.875	3	1242.4	2733
30T-36T	1000	39	0.984	4	1290.6	2839
30T-36T	1050	42	1.095	4	1338.8	2945
30T-36T	1200	48	1.319	4	1445.3	3180
30T-36T	1380	54	1.548	5	1541.7	3392
30T-36T	1500	60	1.777	5	1638.1	3604
30T-36T	1600	63	1.891	5	1686.8	3711
30T-36T	1680	66	2.006	5	1734.5	3816
30T-36T	1750	69	2.122	6	1782.9	3922
30T-36T	1800	72	2.236	6	1830.9	4028
37T-50T	750	30	0.76	3	1471	3236
37T-50T	900	36	0.95	3	1589	3496
37T-50T	1000	39	1.1	4	1648.7	3627
37T-50T	1050	42	1.2	4	1707.1	3756
37T-50T	1200	48	1.4	4	1824.8	4015
37T-50T	1380	54	1.7	5	1943	4275
37T-50T	1500	60	1.9	5	2061	4534
37T-50T	1600	63	2.1	5	2120.7	4666
37T-50T	1680	66	2.2	5	2178.9	4794
37T-50T	1750	69	2.3	6	2238.8	4925
37T-50T	1800	72	2.4	6	2298.4	5056
37T-50T	1980	78	2.7	6	2417.6	5319

EXTREM HEAVY DUTY ROCK BUCKET

More than 15 years of experience building bucket for mining and mass excavation application, TSK bucket enjoy a well-earned reputation for high productivity ,high durability.Our current design reflect numerous productivity and durability improvement.

There are many critical manufacturing approaches required to properly produce buckets with large material thickness. We have necessary equipments,process and trained people to make these buckets enduring in the field.

We have numerous repeat customers,the best testimony to the value and satisfaction our customers enjoy with our large mining and mass excavation buckets.



Standard Features

Cutting edge,side wear plate,back wear strip made of HARDOX400 or equivalent high hardness steel
Replaceable Side cutters for customer easy maintainance.

cutting edge protectors for extended cutting edge life.

Standard CAT style rock teeth.

Available Mining Bucket Options

Custom widths to meet your special production or material capacity requirement
Internal wear bars
Wearing material package(side edge,cutting edge,wear plate,protection packages) Wear bottoms on side and bottom.

Teeth system according to customer specification such as Kmax,Ultra Lock, Twist Lock or Super V
Rock Shear

DITCHING BUCKET

COMPACT EXCAVATORS DITCHING

Up to 8T/18000 lbs

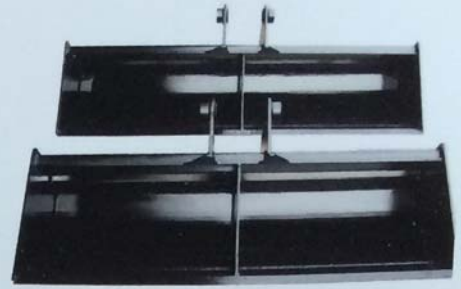

Machine Weight	Width (mm)	Width (inch)	Volume (VRm3)	Teeth	Mass(kg)	Mass(lbs)
0.8T	760	30	0.08		71.60	158
1T-2T	1000	40	0.09		82.00	180
2T-3T	1200	48	0.17		122.00	268
3T-4T	1200	48	0.32		159.00	350
4T-6T	1200	48	0.33		212.10	467
4T-6T	1500	60	0.42		239.55	527
6T-8T	1500	60	0.5		314.00	691

From 12T Up To 50T 26400 lbs Up To 11000 lbs



Machine Weight	Width (mm)	Width (inch)	Volume (VRm3)	Teeth	Mass(kg)	Mass(lbs)
10T-12T	1200	48	0.66		373	821
13T-16T	1500	60	0.91		559	1230
13F-16F	1800	72	1.12		625	1375
17T-21T	1800	72	1.56		980	2156
22T-28T	1800	72	1.56		1213	2669
22T-38T	2000	80	1.74		1302	2864
30T-38T	18000	72	1.76		1284	2825
30T-38T	2000	80	1.97		1370	3014
40T-45T	2000	80	2.52		1751	3852
40T-45T	2400	96	3.1		1954	4299

CLAM SHELL BUCKET

Available for Excavators 2T to 30T 50800 lbs Up to 66000lbs

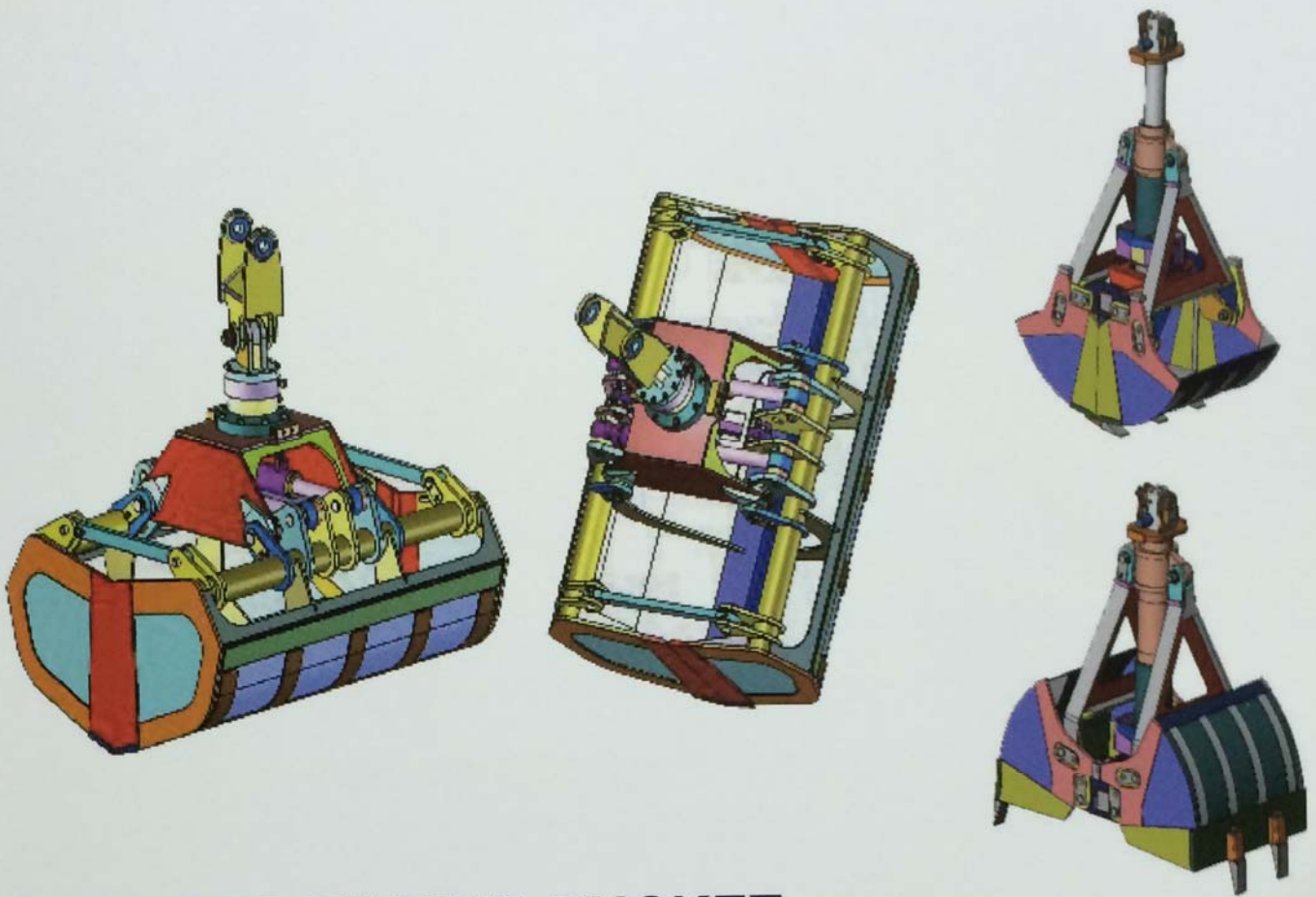

CYLINDER TILTING BUCKET

Available From 1T till 20T 2200lbs Up to 44000lbs

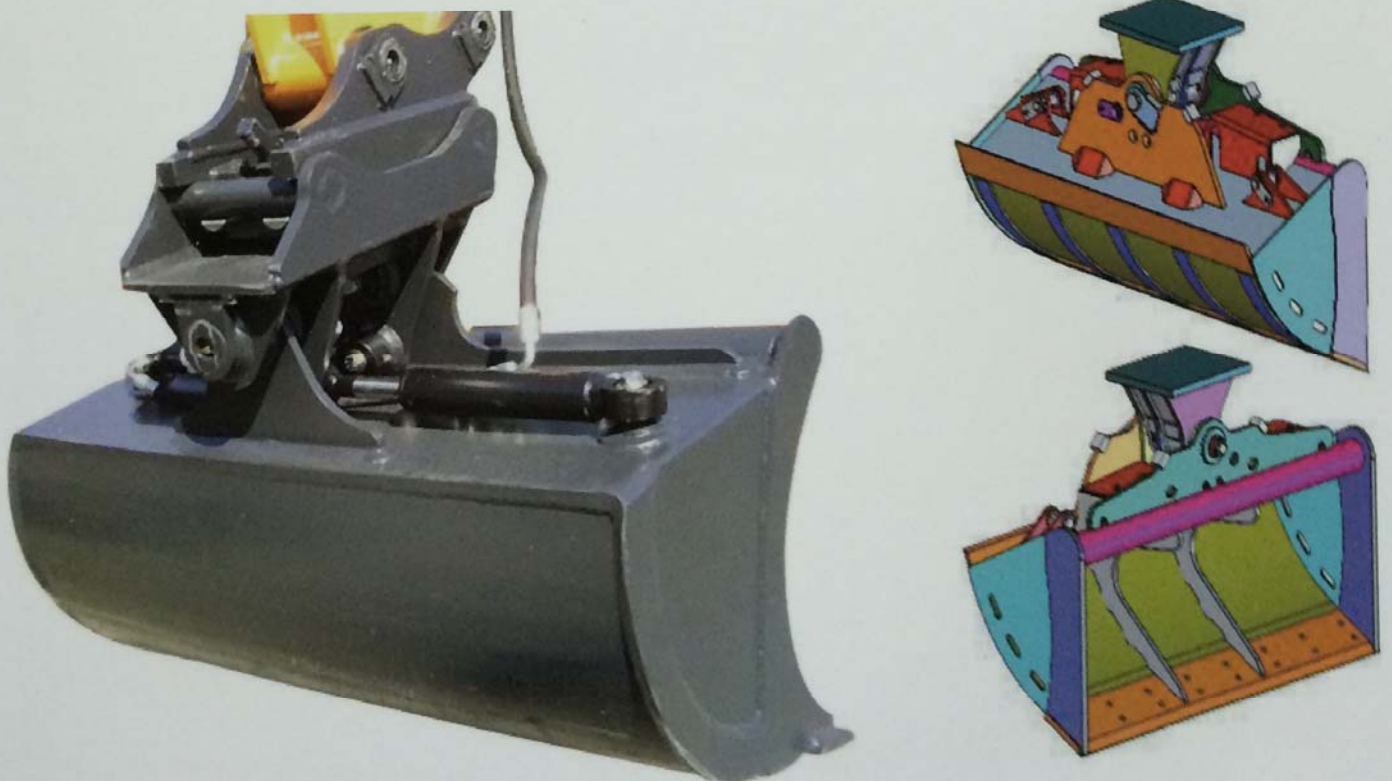

RIPPER

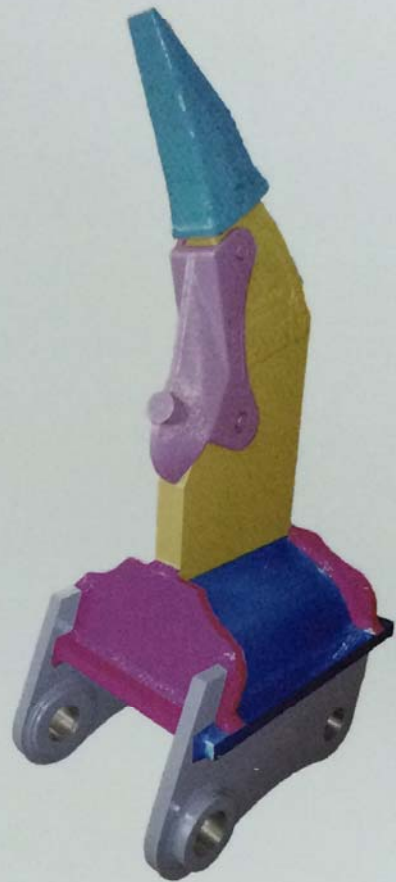

Machine Weight	Shank Thickness mm	Shank Thickness inch	Mass(kg)	Mass (inch)
13T	60	2	380	836
16T	60	2	540	1188
20T	80	3	680	1496
26T	90	4	750	1650
30T	90	4	820	1804
36T	100	4	870	1914
40T	100	4	940	2068
45T	100	4	980	2156

LODAER BUCKET

CAT2900 CAT1700 CAT1300

Loader Bucket



TELEHANDLER BUCKET



WHEEL LOADER BUCKET



SKELETON BUCKET

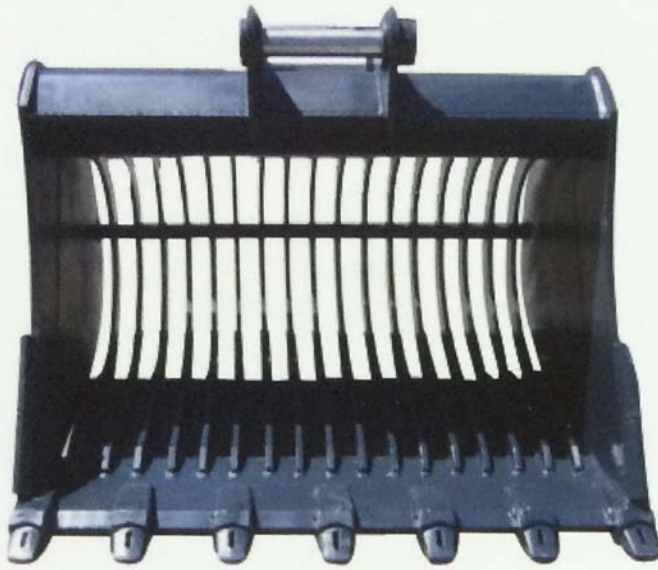

GRAPPLE



FLAT BUCKET



TRAPZOIDAL BUCKET



THUMB

Available from 4T Up To 40T 101600 lbs Up to 1016000 lbs



WEDGE STYLE QUICK COUPLER BUCKET

For Excavator Up to 40T 880001bs



TIMBER GRIP

Model	Mass (kg)	Machine Weight	Machine Weight(lbs)	
16S	82	180	2T	50800
22S	190	418	3T	76200
25S	291	640	4T	101600
28S	374	823	10T	254000
35S	415	913	12T	3657600
42S	535	1177	14T	355600
55S	857	1885	20T	508000



STONE GRIP

Model	Mass (kg)	Machine Weight	Machine Weight(lbs)	
28ST	416	915	10T	254000
42ST	555	1221	14T	355600
55ST	1058	2328	30T	762000



DEMOLITION GRIP

Model	Mass (kg)	Machine Weight	Machine Weight(lbs)	
15	233	513	5T	127000
20	528	1161	10T	254000
25	1028	2262	17T	431800
30	1595	3509	22T	558800
35	1739	3826	25T	635000



► QA .QC

SHOW ME HOW YOU MAKE QUALITY ATTACHMENTS

QUALITY AND CUSTOMER SATISFACTION

Envirement

5S System In Place

Methods

FMEA, ContolPlan, SOP, CAT Five Records In Place

Machines

Sate of Art Equipments Three Plasma Cuting Machines Full Direction welding Tables Boring and others

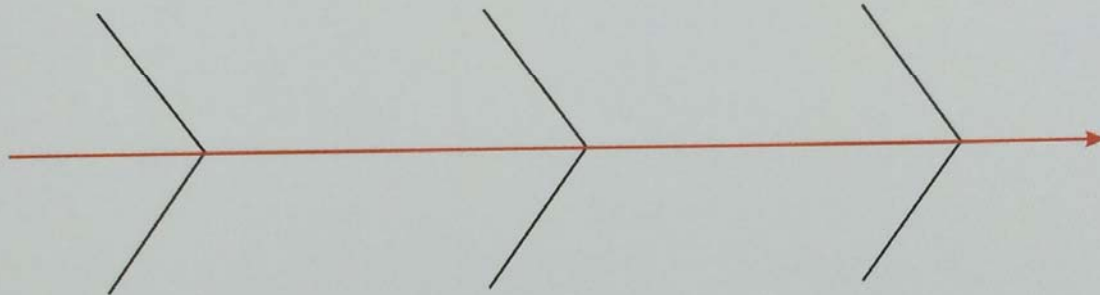

Measuremen

100% UC welding Test,Dimenssion Check,Paint thickness,shinenessTest Incoming Material Test.

Material

SSAB HARDOX and Other Best steel used Incoming Material Test

Man

Comprehensive Training Incentives,Creer Planing,Company Culture Building.

Machine

Sate of Art Equipments



Three units of Large Power Plasma Cutting Enssure clean and efficient Steel cuting.



Full direction Welding Platform Enssure good and efficient welding.



CNC Boring Machine Enssure Preciese Hanger Dimension.

Material

SSAB HARDOX and Other Best steel used Strict Copre hensive Incoming Material Test.

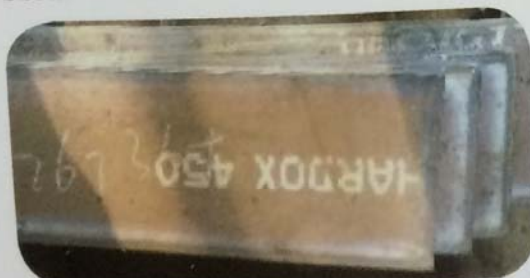

PACKING



8t Bucket Packing



Mini Bucket packing



Mini Bucket Packing



20Ton Bucket Packing

CERTIFICATE

CE Certified ISO9001 Issued By TUV-Strictest ISO9001 Approval in China

Certificate

Standard: ISO 9001:2008
 Certificate Register No.: 21 102 148255

Certificate Holder:
 Tianjin TSK Mechanical Equipment Co., Ltd
 No. 101 Guangshu Road, Jinghai New Economic Development Zone, Tianjin (4) 311800, P. R. China

Scope:
 Manufacturing of Track Rollers, Center Rollers, Sides for Crawler Construction Machinery

VERBS:
 This certificate is valid from 2011-03-07 until 2014-03-07

2014-03-07

TÜV Rheinland
 Priority Right

CERTIFICATE OF CONFORMITY

CERTIFICATE No. 100903/SI876

MANUFACTURER:
 NAME: SUNTRAC INDUSTRIAL CO. LTD
 ADDRESS: ROOM 1305, YU DU COMMERCIAL BUILDING, NO 632, ZHONGSHAN BEIFANG ROAD, HANGZHOU, ZHEJIANG, CHINA

WE CERTIFY THAT THE FOLLOWING PRODUCT (S):

PRODUCT	BUCKET
MODEL	Q501, Q502, Q503, Q504, Q505, Q506, Q507, Q508
YEAR	2010

2006/42/EC MACHINERY DIRECTIVE
 EN ISO 12100-1, EN ISO 12100-2, EN 614-3, 2008

SAFETY STANDARDS EN NORMS
 EN ISO 12100-1, EN ISO 12100-2, EN 614-3, 2008

DATE OF ISSUE: SEPTEMBER 2010

ENVI CERTIFICATION MACHINE
 No. 100903/SI876

CERTIFICATE OF CONFORMITY

CERTIFICATE No. 100903/SI876

MANUFACTURER:
 NAME: SUNTRAC INDUSTRIAL CO. LTD
 ADDRESS: ROOM 1305, YU DU COMMERCIAL BUILDING, NO 632, ZHONGSHAN BEIFANG ROAD, HANGZHOU, ZHEJIANG, CHINA

WE CERTIFY THAT THE FOLLOWING PRODUCT (S):

PRODUCT	BUCKET
MODEL	ST01, ST02, ST03, ST04, ST05, ST06, ST07, ST08
YEAR	2010

2006/42/EC MACHINERY DIRECTIVE
 EN ISO 12100-1, EN ISO 12100-2, EN 614-3, 2008

SAFETY STANDARDS EN NORMS
 EN ISO 12100-1, EN ISO 12100-2, EN 614-3, 2008

DATE OF ISSUE: SEPTEMBER 2010

ENVI CERTIFICATION MACHINE
 No. 100903/SI876

APPLICATIONS LIST

BOBCAT

X316 X320/X322 X325/328 X331 X335/435 X442

CASE

C28 CX16B CK25 CX50 CX20B CX27B CX40B CX75 580 CX130 CX160 CX210 CX240LR CX350

CAT

CAT30L5 CAT30L8 CAT302.5 CAT303C CAT304C CAT305C CAT432 CAT438 CAT428 CAT312 CAT325

CAT320D CAT330D CAT336D CAT345D R2900 R1700 R1300 988H TH330B

NEUSON

503 3003 1403

KOBELCO

SK80 SK140 SK170 SK210 SK250 SK350 SK460

SUMITOMO

SH130 SH200 SH240 SH330 SH450

HANIX

H08B H09D H15A H26C H36C H55DR

HITACHI

EX08 EX15 EX17 EX22 EX30 EX60-3 ZX27U-3 ZX35U-3 ZX50U-3 ZX60U ZX80 ZX130 ZX160

ZX210 ZX250H33 ZX350 ZX470H-3

JCB

JCB Micro JCB801 JCB802 JCB8025 Ded Hitch JCB803 JCB8035 Ded Hitch JCB804.5 JCB8052 JCB8052

JCB GraveDigger JCB1CX JCB2CX JCB3CX JZ070 JS130 JS160 JS220 JS360 JS175W JCB535 Telehandler

KOMATSU

PC03/09 PC12 PCM16R-3 PC18MR2 PCM27-8 PCM27R-8 PC28 PCM55MR-3 PC78 PCM80MR PC138 PC160

PC200 WB97 WB93-2 PC200 PC210 Shaker PCM110 PC138 PC270 PC300 PC350/PC360 PC400 PC450 PC650

KUBOTA

K008-3 KX36-3 KX41-3 KX61-3 KX71-3 KX91-3 KX91/101 KX121-3 KX161-3 KX080-3

TAKEUCHI

TB007 TB108 TB014 TB015 TB016 TB025 TB035/235 TB250/045 TB125 TB153 TB175

VOLVO

EC15 EC20 EC25 EC35 EC55 BL71 EC88R EC140 EC160 EC210C EC240LR EC290C EC360 EC460C 2W180

YANMAR

B08-3 B25 B27 VIO17 VIO30 VIO45 VIO55 VIO75 VIO80

DAEWOO

DAE030 DAE055

MANITOU

1.5m3 2m3 1m3

NEW HOLLAND

E70SR LB110

NEW HOLLAND

LB110

TEREX

760 860

DOOSAN

DX80 DX140 DX180 DX225 DX300 DX370 DX420 DX500

HYUNDAI

R140 R170 R210 R215 R225 R250 R265 R305 R335 R360 R375 R455 R505